

*****PRELIMINARY*****

1990 "D" LEAGUE TEAM ROSTER AND MANAGERS LIST

<u>TEAM</u>	<u>MANAGER</u>	<u>M/S</u>	<u>EXT</u>
P-51s	Ed McNevin*	303-220	4-2195
Paper Tigers	Stu Imai	190-220	42070
Technicalities	Holly Hargis	198-105	4-7645
	Denise Pearson**	180-500	4-6753
Vortex	Steve Moore	183-901	4-1922
Bombers	Dick Green	122-113	4-3703
	Cory Borst	186-Aud	4-6170
Sec 342 (name TBD)	Peter Gluck	303-300	4-9425
B-52s	Al Brejcha	301-460	4-3080
	Bob Koukol	190-112	4-4710
IR Sox	Tom Chester	100-22	584-2909
	Dennis Whitman	100-22	584-2969
X-Terminators	Toby Solorzano	249-101E	4-5151
Single Event Upsets	Neal Ausman	264-419	4-2264

- * League Director- give him h--- when he screws up.
- ** League Registrar- report all roster changes to her.
- *** D League equipment will be kept in Bldg 303-205
Equipment monitor will be Ed McNevin, X4-2195
Home team pick up on game day between 1:00pm-4:00pm.
Return equipment day after game BEFORE 11:00am.

FINAL 1990 "D" LEAGUE STANDINGS

<u>TEAM NAME</u>	<u>WON</u>	<u>LOST</u>	<u>PCT</u>	<u>G/B</u>	<u>GAMES POSTPONED</u>
TECHNICALITIES	16	2	.889	-	-
DIAMOND CUTTERS	15	3	.833	1	-
P-51s	13	5	.722	3	-
VORTEX	13	5	.722	3	-
PAPER TIGERS	9	8	.529	6 1/2	1
S.E.U.	6	11	.353	9 1/2	1
B-52s	5	11	.313	10	2
BOMBERS	4	12	.250	11	2
I.R. SOX	4	13	.235	11 1/2	1
POWERHOUSE	1	16	.059	14 1/2	1

PLEASE NOTE:

THIS TABULATION REPRESENTS MY BEST INFORMATION AS TO THE FINAL OUTCOME OF THE 1990 SEASON. DUE TO GAMES THAT HAVE BEEN RESCHEDULED AND/OR GAME RESULTS NOT REPORTED THERE MAY BE INADVERTENT ERRORS IN THIS LISTING. IF YOU HAVE BETTER INFORMATION PLEASE PROVIDE IT TO ME AND I WILL HAPPILY CHANGE THE STANDINGS ACCORDINGLY. THANKS FOR YOUR HELP AND COOPERATION, AND CONGRATULATIONS TO THE "TECHNICALITIES" WHO ARE THE UNDISPUTED 1990 "D" LEAGUE CHAMPIONS..

REGARDS,

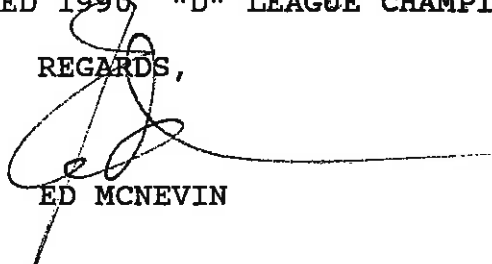

ED MCNEVIN

OFFICIAL 1991 "D" LEAGUE TEAM ROSTER AND MANAGERS LIST

#	NAME	MANAGER	M/S	EXT
1.	P-51s	Ed McNevin * Ed Powell	303-220 303-230	4-2195 4-0308
2.	Paper Tigers	Stu Imai	190-220	4-2070
3.	Technicalities	Holly Hargis	198-105	4-7645
4.	Vortex	Steve Moore	183-901	4-1922
5.	The Flacks	Skip McNevin Yvonne Samuel	180-201 180-201	4-7006 4-7006
6.	The Powerhouse	Peter Gluck	303-300	4-9425
7.	B-52s	Al Brejcha Bob Koukol **	301-460 190-112	4-3080 4-4710
8.	IR Sox	Tom Chester Dennis Whitman	100-22 100-22	584-2909 584-2969
9.	Single Event Upsets	Neal Ausman	264-419	4-2446

* League Director- give him "H---" when he screws up.

** Equipment monitor will be Bob Koukol, X4-4710
Equipment is kept at Bldg 190-112 (see map)
Home team pick up on game day between 1:00pm-4:00pm.
Return equipment day after game BEFORE 11:00am.
REMEMBER, WHEN YOU ARE PLAYING TEAM # 8, THE "IR SOX" YOU
ARE TO BRING THE EQUIPMENT TO THE FIELD EVEN IF YOU ARE
THE VISITING TEAM !!!

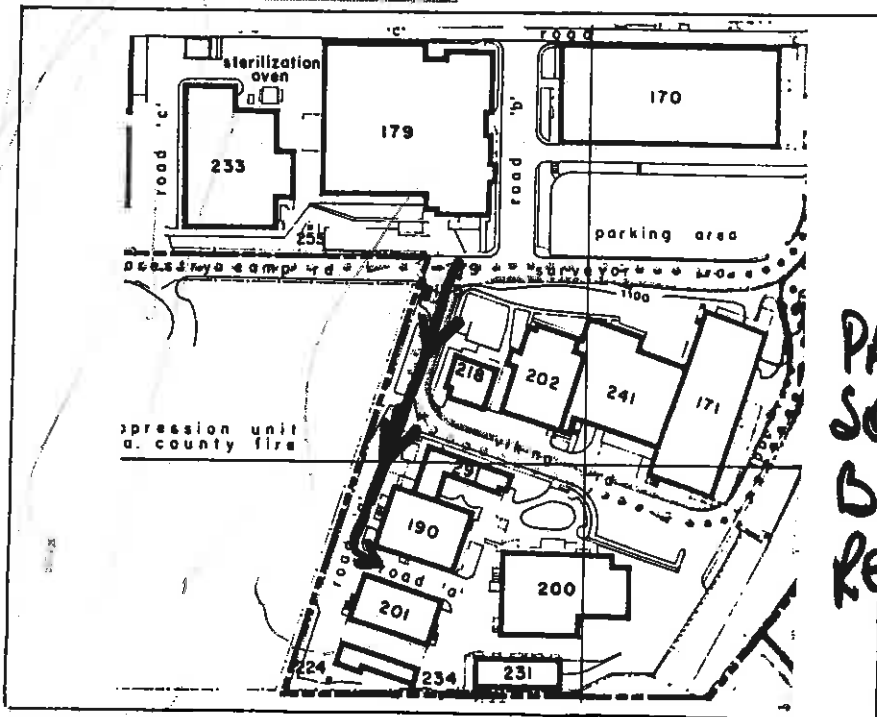

PARK ON
SOUTH SIDE OF
Bldg 190. ENTER
REAR DOOR.

OFFICIAL 1992 "D" LEAGUE TEAM ROSTER AND MANAGERS LIST

<u>TEAM #</u>	<u>TEAM NAME</u>	<u>MANAGER</u>	<u>MAIL STA</u>	<u>EXT</u>
1.	P-51s	ED MCNEVIN ED POWELL	303-230 303-230	42195 40308
2.	PAPER TIGERS	STU IMAI	190-220	42070
3.	TECHNICALITIES	HOLLY HARGIS	198-105	47645
4.	VORTEX	STEVE MOORE	183-901	41922
5.	THE FLACKS	SKIP MCNEVIN CORY BORST	180-201 186-AUD	47006 46170
6.	THE POWERHOUSE	PETER GLUCK	303-300	49425
7.	B-52s	BOB KOUKOL AL BREJCHA	190-112 301-460	44710 43080
8.	IR SOX	DENNIS WITTMAN	100-22	584-2969
9.	SINGLE EVENT UPSETS	GARY SPRADLIN	525-142A	66008
10.	UNACCOUNTABLES	MARY PICKERING RANDY GUTHRIE	241-204 241-204	48669 49308

LEAGUE DIRECTOR- ED MCNEVIN, 42195

EQUIPMENT MONITOR- ED MCNEVIN, BLDG 303 (SEE SPECIAL INFO)

**HOME TEAM PICK UP EQUIP'T BETWEEN 1PM AND 4PM ON DAY OF GAME AND RETURN EQUIP'T BEFORE 11AM THE NEXT DAY.

**REMEMBER THAT IF YOU ARE PLAYING THE "IR SOX" YOU ARE TO BRING THE EQUIP'T TO THE FIELD EVEN IF YOU ARE NOT THE HOME TEAM.

1992 "D" LEAGUE SCHEDULE

FIRST HALF SEASON ONLY

FIRST LISTED TEAM IS HOME TEAM W/ EQUIP'T RESPONSIBILITY

WEEK OF ↓	MON H5	TUE H5	WED H5	THUR H5	THUR H6
4/27	6-4	5-1	8-2	7-3	9-10
5/4	5-8	2-1	4-9	3-10	6-7
5/11	3-4	9-7	10-6	2-5	1-8
5/18	5-10	3-1	4-2	7-8	6-9
5/25	HOLIDAY	5-6	3-8	1-10	4-7 2-9 (TBD)
6/1	8-9	4-1	7-10	6-2	5-3
6/8	4-5	2-7	3-6	10-8	1-9
6/15	9-3	6-1	10-2	7-5	8-4
6/22	10-4	2-3	8-6	7-1	9-5

6/29

NO GAMES SCHEDULED THIS WEEK

SECOND HALF SCHEDULE WILL START WEEK OF 7/6

**ALL GAMES START AT 5:30 PM SHARP

**NOTE SECOND THURSDAY GAME PLAYED ON FIELD #H-6 (SEE MAP)

**HOME TEAM PICK UP EQUIP'T BETWEEN 1:00PM AND 4:00PM DAY OF GAME
AND RETURN EQUIP'T BEFORE 11AM DAY AFTER GAME

**REMEMBER, WHEN PLAYING "IR SOX" (TEAM #8) PICK UP EQUIP'T EVEN IF
YOU ARE NOT THE HOME TEAM

REPORT SCORES TO ED MCNEVIN,

X42195

SPECIAL INFORMATION FOR "D" LEAGUE TEAM MANAGERS

1. NOTE MAP BELOW WITH FIELD LOCATIONS. THURSDAY GAMES WILL BE PLAYED ON BOTH H-5 AND H-6. NOTIFY YOUR PLAYERS OF THIS CHANGE.
2. ED MCNEVIN WILL BE EQUIPMENT MONITOR FOR THIS SCHEDULE. THE EQUIPMENT SETS WILL BE STORED IN BLDG 303 RM 205 (UTILITY ROOM). ACCESS IS THRU THE REAR LOADING DOCK DOOR OF BLDG 303.
3. ALL TEAMS WILL BE ISSUED A SUPPLY OF NEW SOFTBALLS. THE HOME TEAM WILL PROVIDE A GAME BALL FROM THIS INVENTORY. TEAM MANAGERS SHALL KEEP USED GAME BALLS FOR USE AS BACK-UP BALLS IN GAMES AND FOR PRE-GAME PRACTICES. TEAM MANAGERS WILL ASSUME RESPONSIBILITY FOR STORAGE OF THE SOFTBALLS AND NO REPLACEMENT BALLS WILL BE ISSUED IF BALLS ARE MISPLACED OR MISUSED.
4. STRICT OBSERVANCE OF THE NO-ALCOHOL RULE WILL BE EXPECTED THIS YEAR AND REPEATED VIOLATIONS CAN RESULT IN INDIVIDUAL OR TEAM SUSPENSIONS.

ROSE BOWL AREA H

SOFTBALL FIELDS
RESERVED BY JPL

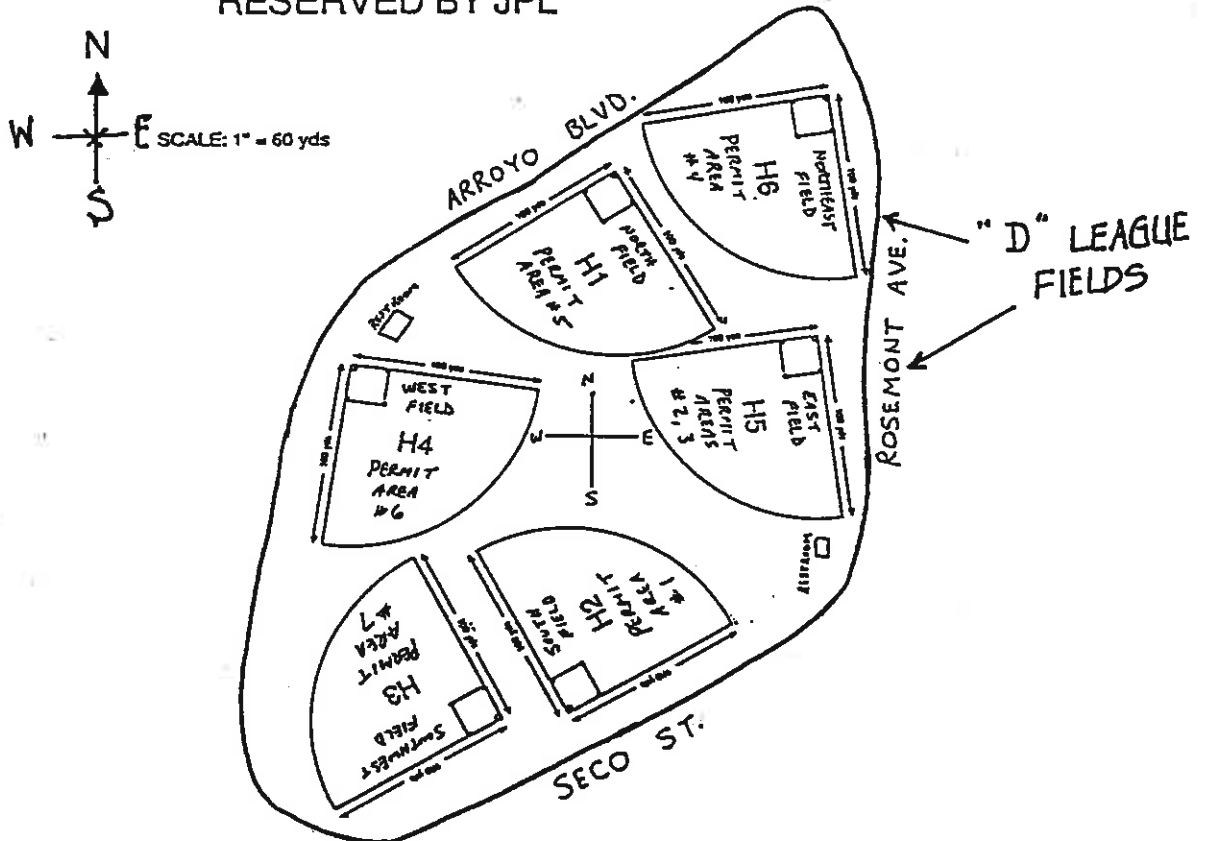

REGULAR SEASON BEGINS WEEK OF APRIL 27. ALL GAMES WILL BE PLAYED

ON FIELDS H5 OR H6. ALL GAMES START PROMPTLY AT 5:30.

FOR INFORMATION CONTACT E. MC NEVIN @ 4-2195

1992 "D" LEAGUE STANDINGS
STANDINGS AS OF END OF FIRST HALF

<u>TEAM NAME</u>	<u>WON</u>	<u>LOST</u>	<u>TIE</u>	<u>GAMES BEHIND</u>
<u>PAPER TIGERS</u>	<u>7</u>	<u>1</u>		<u>---</u>
<u>VORTEX</u>	<u>6</u>	<u>2</u>		<u>1</u>
<u>TECHNICALITIES</u>	<u>5</u>	<u>2</u>		<u>1 1/2</u>
<u>I R SOX</u>	<u>5</u>	<u>3</u>		<u>2</u>
<u>SINGLE EVENT</u>	<u>4</u>	<u>3</u>		<u>2 1/2</u>
<u>P-51s</u>	<u>4</u>	<u>3</u>	<u>1</u>	<u>2 1/2</u>
<u>FLACKS</u>	<u>4</u>	<u>4</u>		<u>3</u>
<u>POWERHOUSE</u>	<u>3</u>	<u>6</u>		<u>4 1/2</u>
<u>B-52s</u>	<u>1</u>	<u>6</u>	<u>1</u>	<u>5 1/2</u>
<u>UNACCOUNTABLES</u>	<u>0</u>	<u>8</u>		<u>7</u>

* * * * *

GAME SCORES TO DATE **

<u>WEEK #8</u>		<u>WEEK #9</u>	
<u>TECH</u>	<u>11</u>	<u>VORTEX</u>	<u>6</u>
<u>SEU</u>	<u>4</u>	<u>UNACCTBL</u>	<u>3</u>
<u>PWRHSE</u>	<u>15</u>	<u>PPR TGR</u>	<u>9</u>
<u>P-51s</u>	<u>14</u>	<u>TECH</u>	<u>6</u>
<u>PPR TGR</u>	<u>14</u>	<u>IR SOX</u>	<u>21</u>
<u>UNACCTBL</u>	<u>4</u>	<u>PWRHSE</u>	<u>14</u>
<u>FLACKS</u>	<u>15</u>	<u>B-52s</u>	<u>17</u>
<u>B-52s</u>	<u>7</u>	<u>P-51s</u>	<u>17</u>
<u>VORTEX</u>	<u>8</u>	<u>SEU</u>	<u>PPD</u>
<u>IR SOX</u>	<u>3</u>	<u>FLACKS</u>	<u>(LYMAN PARTY)</u>

**I WILL MAINTAIN THE PRACTICE OF REPORTING SCORES FOR ALL GAMES PROVIDED THE INFO IS GIVEN TO ME BY THE WINNING MGR.

1992 "D" LEAGUE STANDINGS

*** FINAL STANDINGS ***

<u>TEAM NAME</u>	<u>WON</u>	<u>LOST</u>	<u>TIE</u>	<u>GAMES BEHIND</u>
<u>PAPER TIGERS</u>	<u>12</u>	<u>4</u>	<u>1</u>	<u>---</u>
<u>VORTEX</u>	<u>12</u>	<u>5</u>		<u>1/2</u>
<u>SINGLE EVENT</u>	<u>11</u>	<u>4</u>	<u>1</u>	<u>1/2</u>
<u>P-51s</u>	<u>10</u>	<u>6</u>	<u>1</u>	<u>2</u>
<u>I R SOX</u>	<u>10</u>	<u>7</u>		<u>2 1/2</u>
<u>FLACKS</u>	<u>8</u>	<u>8</u>		<u>4</u>
<u>TECHNICALITIES</u>	<u>7</u>	<u>9</u>		<u>5</u>
<u>POWERHOUSE</u>	<u>5</u>	<u>12</u>		<u>7 1/2</u>
<u>B-52s</u>	<u>4</u>	<u>12</u>	<u>1</u>	<u>8</u>
<u>UNACCOUNTABLES</u>	<u>3</u>	<u>13</u>		<u>8 1/2</u>

* * * * *

SINCE THIS IS THE LAST REPORT I WANT TO THANK YOU ALL FOR A VERY SUCCESSFUL SEASON WHICH WAS, I THINK, VIRTUALLY PROBLEM FREE (EXCEPTING THE NONSENCE VISITED UPON OUR MEASLY HEADS BY THE OMNIPOTENT AND ALL-POWERFUL WONDERFUL WIZARD OF PASADENA). HAVE A NICE FALL AND WINTER---SEE YOU NEXT YEAR !!!

REGARDS, ED MCNEVIN

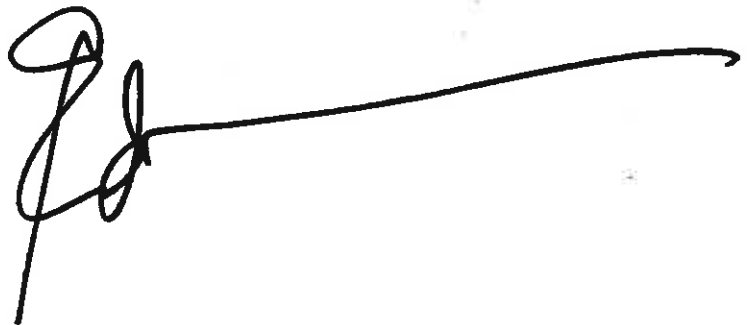

1993 "D" LEAGUE TEAM ROSTER AND MANAGERS LIST

<u>TEAM #</u>	<u>TEAM NAME</u>	<u>MANAGER</u>	<u>MAIL STA</u>	<u>EXT</u>
1.	P-51s	ED MCNEVIN ED POWELL	303-230 303-230	42195 40308
2.	PAPER TIGERS	STU IMAI	190-220	42070
3.	VORTEX	RANDY FRIEDL	183-901	43800
4.	THE FLACKS	SKIP MCNEVIN CORY BORST	180-201 186-AUD	47006 45011 46170
5.	POWERHOUSE	KARLA CLARK JOHN BENNETT	303-300 303-300	49033 40694
6.	B-52s	BOB KOUKOL AL BREJCHA	190-112 301-460	44710 43080
7.	IR SOX	DENNIS WITTMAN	100-22	79569
8.	SINGLE EVENT UPSETS	GARY SPRADLIN	525-142A	66008

**** NOTE THAT SOME TEAM NUMBERS ARE CHANGED FOR 1993 ****

LEAGUE DIRECTOR- ED MCNEVIN, 42195

EQUIPMENT MONITOR- ED MCNEVIN, BLDG 303-204F (M/S 303-230)

****HOME TEAM PICK UP EQUIP'T BETWEEN 1 PM AND 4 PM ON DAY OF GAME AND RETURN EQUIP'T BEFORE 11 AM THE NEXT DAY.**

****REMEMBER THAT IF YOU ARE PLAYING THE "IR SOX" YOU ARE TO BRING THE EQUIP'T TO THE FIELD EVEN IF YOU ARE NOT THE HOME TEAM.**

JPL "D" LEAGUE RULES AND REGULATIONS; 1993

1. OBJECTIVES

THE OBJECTIVES OF THE "D" LEAGUE ARE;

- A) TO PROVIDE FRIENDLY COMPETITION AND ENCOURAGE PARTICIPATION IN THE SPORT OF SLOW PITCH SOFTBALL BY JPL EMPLOYEES WHO ARE ASSOCIATED WITH A DIVISION OR PROGRAM OFFICE.
- B) TO FIELD EVENLY MATCHED TEAMS.
- C) TO PROVIDE A GOOD ENVIRONMENT FOR VARIOUS JPL ORGANIZATIONS AND THEIR PEOPLE TO GET TO KNOW EACH OTHER.

2. "D" LEAGUE TEAM ROSTERS

"D" LEAGUE TEAMS SHALL BE FORMED PRIMARILY OF JPL EMPLOYEES WHO ARE ASSOCIATED WITH A PARTICULAR PROGRAM OR INSTITUTIONAL OFFICE. SKILL LEVELS GENERALLY ARE LESS THAN THOSE OF THE JPL COMPETITIVE LEAGUES. TEAM ROSTERS ARE TO BE COMPRISED PREDOMINANTLY OF JPL OR CONTRACTOR EMPLOYEES AND MEMBERS OF THEIR IMMEDIATE FAMILIES AS DEFINED IN THE JPL/ERC BYLAWS.

3. SCHEDULES

THE LEAGUE DIRECTOR SHALL ISSUE THE SCHEDULE OF GAMES AT LEAST ONE CALENDAR WEEK PRIOR TO THE START OF SCHEDULED PLAY. IN THE EVENT OF AN UNAVOIDABLE CANCELLATION THE CANCELLING TEAM MANAGER SHOULD CALL THE OPPOSING TEAM MANAGER AS SOON AS POSSIBLE SO THAT EARLY NOTICE CAN BE GIVEN TO OTHER PLAYERS AND EVERY REASONABLE ATTEMPT CAN BE MADE TO RESCHEDULE THE GAME.

4. STANDINGS

STANDINGS ARE MAINTAINED TO OBSERVE HOW WELL TEAMS ARE MATCHED. THE DESIGNATED HOME TEAM MANAGER SHALL REPORT SCORES TO THE LEAGUE DIRECTOR WHO WILL ISSUE PERIODIC STANDINGS. NO AWARDS SHALL BE GIVEN AS A RESULT OF REPORTED STANDINGS.

5. "D" LEAGUE RULES OF PLAY

A) GENERAL RULES

ALL GAMES SHALL BE PLAYED UNDER THE RULES OF SLOW PITCH SOFTBALL DESCRIBED IN;

1. THE CURRENT SCMAF RULES
2. THE JPL SOFTBALL PROGRAM RULES
3. THE SPECIAL "D" LEAGUE RULES AS STATED HEREIN.

"D" LEAGUE RULES (cont'd)

A) BATTING ORDER

ALL PLAYERS PRESENT FOR A GAME SHALL BAT WHETHER PLAYING A FIELDING POSITION OR NOT. BATTING ORDERS SHALL BE SET PRIOR TO THE START OF THE GAME AND SHALL HAVE MALE/FEMALE PLAYERS EQUALLY DISTRIBUTED THROUGHOUT THE BATTING ORDER (e.g.; 10 males, 5 females= 2m,1f,2m,1f, etc.). BATTING ORDERS SHALL NOT CHANGE DURING THE GAME EXCEPT DUE TO INJURY OR A PLAYER LEAVING THE GAME FOR PERSONAL REASONS.

B) DEFENSIVE ALIGNMENT

1) A MINIMUM OF EIGHT PLAYERS, INCLUDING AT LEAST THREE FEMALES, ARE REQUIRED TO FIELD A TEAM. FAILURE TO DO SO CONSTITUTES CAUSE FOR FORFEIT.

2) TEN PLAYERS, INCLUDING AT LEAST THREE FEMALES, IS A STANDARD "D" LEAGUE SLOW PITCH SOFTBALL DEFENSIVE ALIGNMENT. THE THREE FEMALES MUST PLAY POSITIONS OTHER THAN CATCHER.

3) TEAMS ARE ALLOWED TO FIELD ELEVEN PLAYERS IN DEFENSIVE POSITIONS PROVIDED AT LEAST FOUR ARE FEMALES PLAYING POSITIONS OTHER THAN CATCHER. THIS ALLOWS FOR HIGHER LEVELS OF PARTICIPATION IN A SEVEN INNING GAME.

C) SUBSTITUTION

FREE SUBSTITUTION IS ALLOWED. PLAYERS MUST SIT OUT AT LEAST ONE FULL INNING BEFORE RETURNING TO A DEFENSIVE POSITION. PLAYERS NOT ASSIGNED A DEFENSIVE POSITION SHALL STILL BAT IN THEIR NORMAL ROTATION.

D) AN OFFICIAL GAME

SHALL START AT 5:30 PM AND SHALL BE COMPRISED OF SEVEN INNINGS. TEAMS ARE ENCOURAGED TO PLAY TO CONCLUSION SO LONG AS SUFFICIENT DAYLIGHT AND SAFE PLAYING CONDITIONS PREVAIL, EVEN IF EXTRA INNINGS ARE REQUIRED.

E) FORFEITURE

TEAMS WILL BE REQUIRED TO FORFEIT GAMES FOR THE FOLLOWING REASONS;

1. FAILURE TO FIELD A TEAM WHICH MEETS THE MINIMUM REQUIREMENTS AS STATED IN (B.1, ABOVE) BY 5:45 PM ON THE DAY OF THE SCHEDULED GAME.
2. THE NUMBER OF PLAYERS AVAILABLE DROPS BELOW THE MINIMUM REQUIREMENTS (B.1, ABOVE) PRIOR TO COMPLETION OF A GAME FOR ANY REASON.

"D" LEAGUE RULES (cont'd)

F) MERCY RULE

TEAMS ACHIEVING AN EIGHT RUN LEAD (OR MORE) SHALL BE LIMITED TO TWO OUTS PER TEAM AT BAT IMMEDIATELY UPON ACHIEVING THE ADVANTAGE. THIS PENALTY SHALL CONTINUE UNTIL THE OPPOSING TEAM REDUCES THE ADVANTAGE BELOW EIGHT RUNS. IT IS THE RESPONSIBILITY OF THE MANAGER OF THE TEAM WITH THE ADVANTAGE TO INFORM THE OPPOSING TEAM IMMEDIATELY.

G) BASE-RUNNING RULES

1. SLIDING- NO SLIDING OF ANY KIND IS PERMITTED IN THE "D" LEAGUE UNDER ANY CIRCUMSTANCES. SLIDING IS DEFINED FOR THIS PURPOSE AS ARRIVING AT OR RETURNING TO ANY BASE IN A PRONE OR SEMI-PRONE POSITION EITHER FEET-FIRST OR HEAD-FIRST.

a. CLARIFICATION- DIVING BACK TO A BASE TO AVOID PICKOFF IS "SLIDING". IF IT IS APPARENT THAT A RUNNER SLIPPED AND FELL WHILE RUNNING TO A BASE THIS SHOULD NOT BE INTERPRETED AS A "SLIDE".

THE PENALTY FOR SLIDING IS THE OFFENDING RUNNER SHALL BE CALLED OUT.

2. INTERFERENCE-

a. RUNNERS MUST AVOID COLLISIONS WITH FIELDERS WHO ARE ATTEMPTING TO CORRECTLY MOVE TO A POSITION TO FIELD A BATTED BALL. RUNNERS CAN BE CALLED OUT IF IN THE UMPIRE'S JUDGEMENT THEY COULD HAVE OR SHOULD HAVE AVOIDED A COLLISION. IN THIS INSTANCE NO OTHER BASERUNNER CAN ADVANCE OR SCORE.

b. FIELDERS MUST AVOID IMPEDING BASERUNNERS ACCESS TO A BASE IF THERE IS NO PLAY AT THAT BASE. FIELDERS MAY BE ASSESSED "INTERFERENCE" PENALTIES WHICH MAY ALLOW BASERUNNERS TO AUTOMATICALLY ADVANCE ANOTHER BASE. FIELDERS DO NOT HAVE THE RIGHT TO STAND NEAR A BASE IN A MANNER SUFFICIENT TO IMPEDE ACCESS UNLESS IT IS EVIDENT THAT A PLAY MAY BE MADE AT THAT BASE.

CLARIFICATION; MANAGERS SHOULD INSTRUCT NOVICE PLAYERS WHO MAY PLAY INFIELD POSITIONS THAT WHEN THE BALL IS DOWN IN THE OUTFIELD THEY SHOULD CLEAR THE VICINITY OF THE BASE TO WHICH THEY HAVE BEEN ASSIGNED AND ALLOW RUNNERS TO MOVE FREELY. ONCE AN OUTFIELD THROW HAS BEEN INITIATED THEY MAY RETURN TO "COVER" THEIR BASE.

"D" LEAGUE RULES (cont'd)

3. SPECIAL HOME PLATE RULE- FOR THE PURPOSE OF AVOIDING SEVERE COLLISIONS NEAR HOME BASE BOTH THE HOME PLATE AND THE STRIKE ZONE MAT SHALL BE CONSIDERED "SAFE" FOR SCORING PURPOSES AND CAN BE USED TO MAKE "OUT" IN A FORCING SITUATION. BASERUNNERS SHOULD BE ENCOURAGED TO SCORE ON THE BACK (STRIKE ZONE MAT) WHILE CATCHERS SHOULD USE THE FRONT (HOME PLATE AREA) FOR THESE PURPOSES.

H) UMPIRE ASSIGNMENTS AND RESPONSIBILITIES

1. UMPIRE ASSIGNMENTS- THE TEAM AT BAT SHALL PROVIDE THE HOME PLATE UMPIRE. A NEUTRAL HOME PLATE UMPIRE CAN BE ASSIGNED BY MUTUAL AGREEMENT BETWEEN MANAGERS. BASE COACHES MAY BE BASE UMPIRES IF PRACTICAL. MANAGERS ARE STRONGLY ENCOURAGED TO IDENTIFY AND USE AS HOME PLATE UMPIRES ONLY THOSE PLAYERS ON THEIR TEAMS WITH EXPERIENCE AND KNOWLEDGE ADEQUATE TO THE TASK.

2. RESPONSIBILITIES-

- a. THE HOME PLATE UMPIRE IS THE PRIMARY OFFICIAL ON THE FIELD AT ALL TIMES AND HAS THE AUTHORITY TO MAKE ALL JUDGEMENT CALLS IF THEY SO DESIRE. THE HOME PLATE UMPIRE SHALL STATE CLEARLY THEIR INTENT TO MAKE ALL CALLS IF SO DESIRED, OR ALTERNATELY CLEARLY ASSIGN RESPONSIBILITY FOR BASE CALLS TO BASE COACHES IF SO DESIRED. THE HOME PLATE UMPIRE SHALL ALSO MAKE ALL BALL/STRIKE, FAIR/FOUL AND OUT-OF-PLAY CALLS. THE HOME PLATE UMPIRE SHALL CONTROL ALL TIME OUTS. ALL APPEALS SHALL BE DIRECTED TO THE HOME PLATE UMPIRE EVEN IF ANOTHER UMPIRE MAKES A DISPUTED CALL. THE HOME PLATE UMPIRE SHALL MAKE FINAL DISPOSITION ON ALL DISPUTED CALLS.

- b. THE BASE COACHES MAY FUNCTION AS BASE UMPIRES BY AGREEMENT WITH THE HOME PLATE UMPIRE, HOWEVER THIS IS NOT AN AUTOMATIC PRIVILEGE AND THE HOME PLATE UMPIRE HAS THE RIGHT TO PREEMPT OR OVERRIDE A JUDGEMENT CALL BY A BASE UMPIRE. BASE COACHES SHOULD WORK CLOSELY WITH HOME PLATE UMPIRES TO OBTAIN THE BEST CALL POSSIBLE IN ALL CASES BUT ESPECIALLY IN THE INSTANCE OF IMPEDED SIGHT LINES OR OTHER PROBLEMS.

TEAM ORIENTATED SUBJECTIVITY SHOULD BE AVOIDED!!

"D" LEAGUE RULES (cont'd)

I) FIELD LAYOUT AND DIMENSIONS

- A) BASELINES- 60 FEET BETWEEN BASES
(ABOUT 20 NORMAL PACES)
- B) PITCHERS "MOUND"- 46 FEET FROM HOME PLATE
(15 NORMAL PACES)
- C) OUTFIELD RETRAINT CONES- 120 FEET FROM HOME PLATE
(40 NORMAL PACES FROM HOME)
- D) OUT-OF-PLAY CONES (OPTIONAL)- 15 FEET OUTSIDE BASES
(5 PACES)
- E) SPECIAL FIELD RELATED ISSUES;
 - 1. 3 OUTFIELDERS OUTSIDE RESTRAINT CONES UNTIL BALL IS STRUCK BY BATTER
 - 2. INFIELERS OUTSIDE (IMAGINARY) LINE BETWEEN BASES UNTIL BALL IS STRUCK BY BATTER
 - 3. ALL SPECTATORS, BALLPLAYERS NOT ON THE FIELD AND EQUIPMENT OUTSIDE THE OUT-OF-PLAY CONES
 - 4. NO METAL SPIKED SHOES ALLOWED ON THE FIELD AT ANY TIME- PENALTY IS EXPULSION FROM GAME.
 - 5. NO ALCHOHOLIC BEVERAGES ALLOWED ON THE FIELD AT ANY TIME BEFORE OR DURING THE GAME